

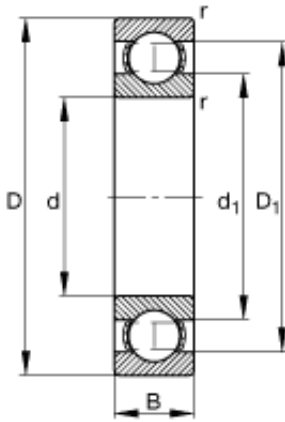

WJE Bearing Manufacturing Co., Ltd.



340 mm x 520 mm x 57 mm FAG 16068-M Single Row Ball Bearings

Bearing No. 16068-M

16068-M Bearing 2D drawings and 3D CAD models

Size	340x520x57 mm
Bore Diameter	340 mm
Outer Diameter	520 mm
Width	57 mm
d	340 mm
D	520 mm
B	57 mm
D_1	457,1 mm
$D_{a \max}$	505,4 mm
d_1	403,6 mm
$d_{a \min}$	354,6 mm
$r_{a \max}$	3 mm
r_{\min}	4 mm
m	47,5 kg / Weight
C_r	355000 N / Dynamic load rating (radial)
C_{0r}	550000 N / Static load rating (radial)
f_0	16,3
n_G	2140 1/min / Limiting speed
n_B	1460 1/min / Reference speed
C_{ur}	17800 N / Fatigue limit load, radial